

编号:

奥德普安全钳OX-188采购附单

备注:

OX-188, 型号: A01, C=220, H=Φ 18

附图如下

OX-188渐进式安全钳  
OX-188 Progressive Safety Gear

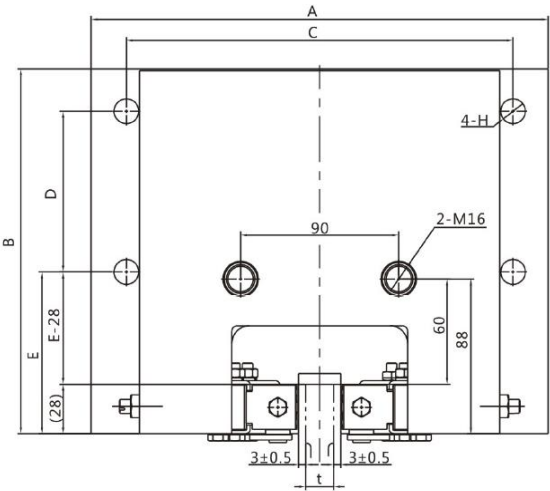
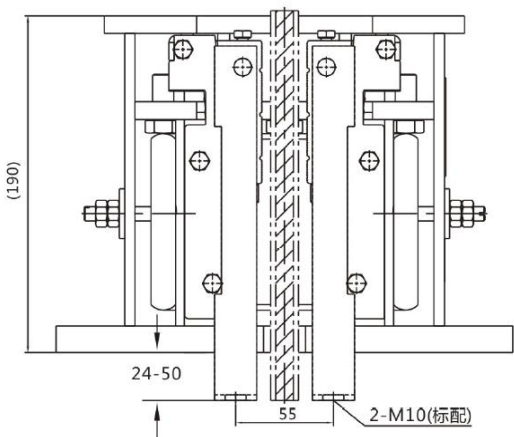

额定速度:  $\leq 2.5\text{m/s}$   
总允许系统质量: 809~5125kg  
匹配导轨: 10mm、15.88mm、16mm(导轨导向面宽度)  
结构形式: U型板簧、双活动楔块  
提拉形式: 双提拉 (标配M10, 可选M8)  
执行标准: GB7588-2003、EN81-1:1998  
安装位置: 轿厢侧、对重侧

型号 Type	A	B	C	D	E	H	匹配导轨 Match the guide shoe
A01	260	206	220	90	92	Φ 18	OX-029
A02	206	206	110			M16	

Rated speed:  $\leq 2.5\text{m/s}$   
Total permit system quality: 809~5125kg  
Matching guide rail: 10mm、15.88mm、16mm(guide rail width)  
Structure form: U-type plate spring、double moving wedge  
Pulling form: double pulling (standard M10、optional M8)  
Performance standard: GB7588-2003、EN81-1:1998  
Installation position: car side、counterweight side

注: 上述为标准产品, 如匹配导轨孔位尺寸变化请按此形式注明: OX-188(A01/63-70×110-M16)(以OX-188(A01)匹配我司OX-02导轨为例的表达形式)

Remarks: The above are standard products, please note in the following form if matching guide shoe size change: OX-188(A01/63-70×110-M16) (example based on OX-188(A01) match with our OX-02 guide shoe)